

벽취부형 패널 (FNLW3)

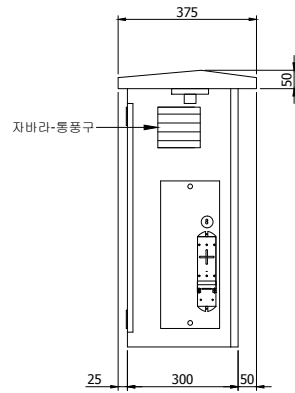

L. SIDE VIEW

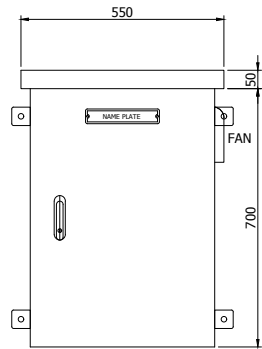

FRONT VIEW

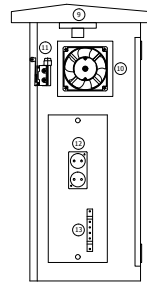

R. SIDE VIEW

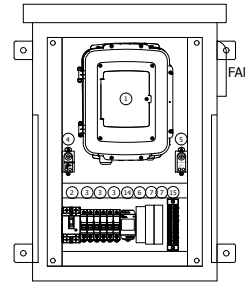

INNER VIEW

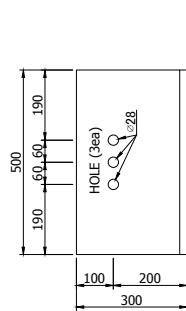

BODY BOTTOM VIEW

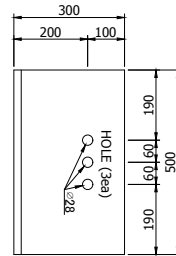
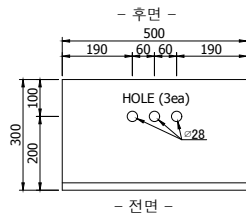

제어반 사양

No	Type & Size	Thickness	Remark
1	Panel 재질 : STS 304	1.5T	
2	Panel 도어 : STS 304	1.5T	
3	Panel 속판 : GI	2.0T	
4	Panel 팬들 : 알루미늄 다이캐스팅		
5	Panel 도어창 : 투명 PC	4.5T	고객요청이 있을 경우 적용
6	Panel 단열시트 : 상부, 전후좌우	10.0T	

Part list

No	Part Name	Type & Size	Sym'Name	Qt'
1	유량계	초음파 & 전자 타입		1
2	MCCB	BK63H 2P 20A	MCCB	1
3	ELCB	32KGRD 15A	ELCB	3
4	온도계	RTM-50H	TS2	1
5	온도계	RTM-50F	TS1	1
6	SPD-POWER	전원용 SPD, 40KA		1
7	SPD-SIGNAL	통신용 SPD, 20KA		2
8	HEATER	100W	HEATER	1
9	LAMP	RLB-5WC	FL	1
10	FAN	120*120	FAN	1
11	리미트 스위치	1A1B	RS	1
12	CONSENT	220V 2구 접지	CON	1
13	접지바	4P	E-BAR	1
14	노이즈 필터	10A	N/F	1
15	고정식 단자대	20A10P	TB	1

현장여건 및 품질개선을 위하여 외형크기, 부품 및 배치, 회로는 변경될 수도 있습니다.

Designed by hbg	Checked by	Approved by	Date	Date 2020.04.01	
FMTECH			벽취부형 패널 (FNLW3)		
			외형도	Edition	Sheet n/a